

UNITED Top Quality Handwheels

Excellent High Quality Economical Handwheels

UNITED'S UNITIZED* HIGH QUALITY LUSTROUS ALUMINUM HANDWHEELS



WITH OR WITHOUT HANDLE

SOLID OR REVOLVING HANDLE

Preferred for their real quality , long wear and good economy. High torque and impact resistance.

These Unitized Handwheels are cast from non-pitting, non-rusting and non-corrosive Aluminum Alloy 319 polished.

Lustrous well-designed, non-slip comfortable finger grips.

DIAMETERS FROM 3 TO 14 INCHES

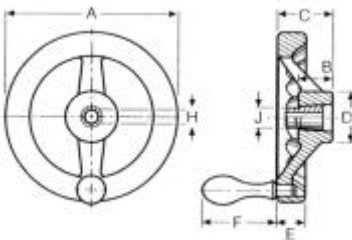

All Styles Shown are available in these standard sizes or custom-machined to your specifications.

NO HANDLE	SOLID HANDLE	REVOLVING HANDLE	A	B	C	D	F	SOLID F	REVOLVING F	H
DIMENSIONS IN INCHES and (METRIC IN PARENTHESSES)										
UDB-800003	UDB-800013	UDB-800023	3" (76MM)	.75 (19MM)	1.13 (29MM)	1.13 (29MM)	.63 (16MM)	1.47 (37MM)	1.38 (35MM)	.375 (9.5MM)
UDB-800004	UDB-800014	UDB-800024	4" (102MM)	.88 (22MM)	1.44 (37MM)	1.31 (33MM)	.75 (19MM)	2.00 (51MM)	2.06 (52MM)	.375 (9.5MM)
UDB-800005	UDB-800015	UDB-800025	5" (127MM)	1.00 (25MM)	1.63 (41MM)	1.50 (38MM)	.81 (21MM)	2.13 (54MM)	2.06 (52MM)	.375 (9.5MM)
UDB-800006	UDB-800016	UDB-800026	6" (178MM)	1.13 (29MM)	2.00 (51MM)	1.75 (44MM)	.88 (22MM)	2.75 (70MM)	3.03 (77MM)	.500 (12.7MM)
UDB-800007	UDB-800017	UDB-800027	7" (178MM)	1.25 (32MM)	2.25 (57MM)	1.75 (44MM)	1.00 (25MM)	3.22 (82MM)	3.28 (83MM)	.500 (12.7MM)
UDB-800008	UDB-800018	UDB-800028	8" (203MM)	1.25 (32MM)	2.38 (60MM)	2.13 (54MM)	1.00 (25MM)	3.22 (82MM)	3.28 (83MM)	.625 (15.9MM)
UDB-800010	UDB-800020	UDB-800030	10" (254MM)	1.38 (35MM)	3" (76MM)	2.50 (64MM)	1.13 (29MM)	3.44 (87MM)	3.28 (83MM)	.625 (15.9MM)
UDB-800012	UDB-800022	UDB-800032	12" (305MM)	1.50 (38MM)	3.25 (83MM)	2.75 (70MM)	1.13 (29MM)	4.06 (103MM)	4.13 (105MM)	.750 (19.1MM)
UDB-800014	UDB-800024	UDB-800034	14" (356MM)	1.75 (44MM)	3.50 (89MM)	3" (76MM)	1.22 (31MM)	4.06 (103MM)	4.13 (105MM)	.750 (19.1MM)

UNITED'S UNITIZED* HIGH QUALITY RED or BLACK ENAMELED HANDWHEELS



DIAMETERS FROM 4 TO 10 INCHES

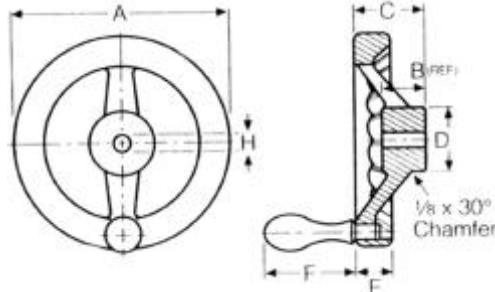

Preferred for their cleaner quality with no black rub-off from aluminum nor rust from cast iron.

High torque and impact resistance.

These Unitized Handwheels are cast 319 aluminum with RED or BLACK long lasting enamel finish.

Lustrous well-designed, non-slip comfortable finger grips.

RED or BLACK ENAMEL FINISH WITH or WITHOUT HANDLE

RED NO HANDLE	BLACK NO HANDLE	RED WITH HANDLE	BLACK WITH HANDLE	A	B	C	D	E	REVOLVING F	H
DIMENSIONS IN INCHES and (METRIC IN PARENTHESSES)										
UDB-818004	UDB-818014	UDB-818024	UDB-818034	4" (102MM)	.88 (22MM)	1.44 (37MM)	1.31 (33MM)	.75 (19MM)	2.06 (52MM)	.375 (9.5MM)
UDB-818005	UDB-818015	UDB-818025	UDB-818035	5" (127MM)	1.00 (25MM)	1.63 (41MM)	1.50 (38MM)	.81 (21MM)	2.06 (52MM)	.375 (9.5MM)
UDB-818006	UDB-818016	UDB-818026	UDB-818036	6" (178MM)	1.13 (29MM)	2.00 (51MM)	1.75 (44MM)	.88 (22MM)	3.03 (77MM)	.500 (12.7MM)
UDB-818007	UDB-818017	UDB-818027	UDB-818037	7" (178MM)	1.25 (32MM)	2.25 (57MM)	1.75 (44MM)	1.00 (25MM)	3.28 (83MM)	.500 (12.7MM)
UDB-818008	UDB-818018	UDB-818028	UDB-818038	8" (203MM)	1.25 (32MM)	2.38 (60MM)	2.13 (54MM)	1.00 (25MM)	3.28 (83MM)	.625 (15.9MM)
UDB-818010	UDB-818020	UDB-818030	UDB-818040	10" (254MM)	1.38 (35MM)	3" (76MM)	2.50 (64MM)	1.13 (29MM)	3.28 (83MM)	.625 (15.9MM)

11-9-98

J12 *Unitized Means High Quality, Functionally Engineered & Competitively Priced!

Black Zinc Die Cast Handwheels With Foldable and Revolving Handles



FOLDABLE REVOLVING HANDLE

Vertical or Horizontal Foldable Black Phenolic Handle fits within the wheel rim.



Black handwheels are made of zinc die casting with your choice of revolving or foldable revolving handles.

REVOLVING HANDLE



**Beauty
Durability
Economy**

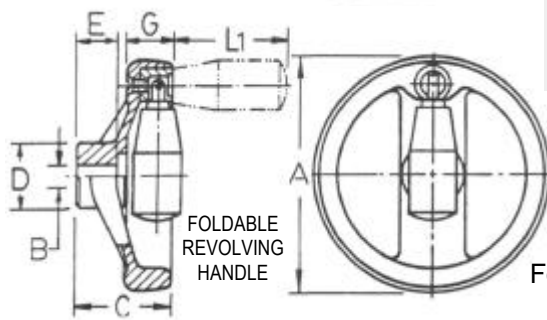

Economical Light Weight Revolving or Foldable Revolving Handles

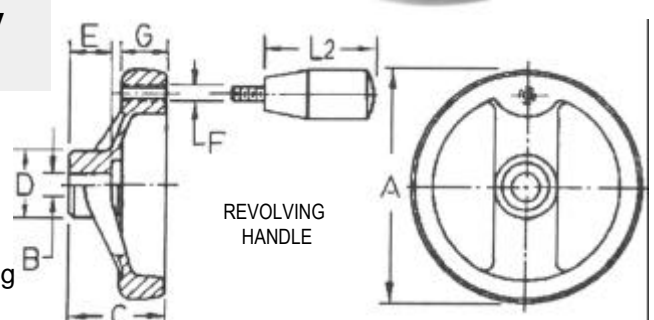

HANDWHEEL WITH FOLDING HANDLE	HANDWHEEL WITH REVOLVING HANDLE	A	B	C	D	E	F	G	REVOLVING L ₁	FIXED L ₂
UDB-936034	UDB-936044	4"	0.375	1-5/8	1-1/8	.67	1/4 20	3.4	2"	2-3/16
UDB-936035	UDB-936045	5"	0.375	1-3/4	1-1/4	.70	5/16 18	7/8	2-1/2	2-1/2
UDB-936036	UDB-936046	6.3	0.500	1-7/8	1-1/2	.80	3/8 16	1"	3-5/32	3-5/32
UDB-936038	UDB-936048	8"	0.625	2-1/8	1-7/8	1.00	3/8 16	1-1/8	3-5/32	3-5/32

**UNITED
Excellence
in design,
strength and
longevity.**

Economical — Light Weight — Revolving Handles

ADJUSTABLE HANDLES — REVOLVING

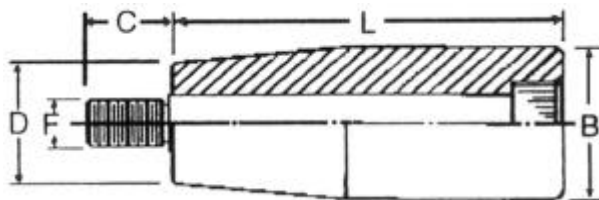

Strong black plastic handle on a socket head shoulder screw.

ADJUSTABLE REVOLVING HANDLE	L	B	C	D	F
UDB-936054	1.96	0.85	0.44	0.67	1/4 20
UDB-936056	2.49	0.93	0.50	0.73	5/16 18
UDB-936058	3.24	1.12	0.50	0.88	3/8 16

UNITED's most popular, most versatile and most economical revolving handle!

Handles — Fixed & Revolving

High Strength Handles Fixed and Revolving

REVOLVING

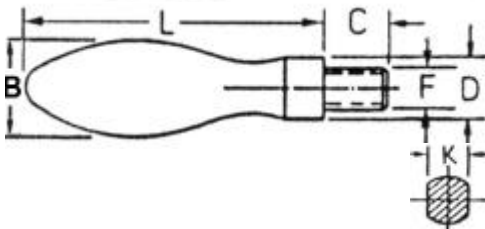

**EXCELLENT QUALITY ELLIPTICAL SHAPED
ALLOY STEEL CHROME HARDENED
HIGH POLISHED HANDLES
ECONOMICAL AND PRACTICAL**

FIXED PART NO.	REVOLVING PART NO.	B DIA	L LEN	F THD	C THD LEN	D HUB DIA	K FLAT THICKNESS
UDB-945270	UDB-945279	1/2	1-11/16 1-7/8	#10-24	3/8	.32	1/4
UDB-945271	UDB-945281	5/8	2" 2-1/4	1/4-20	1/2	.40	5/16
UDB-945272	UDB-945282	13/16	2-5/8 2-13/16	5/16-18	9/16	.51	3/8
UDB-945273	UDB-945283	1"	3-3/16 3-3/8	3/8-16	11/16	.63	7/16
UDB-945274	UDB-945284	1-1/4	3-3/4 4"	1/2-13	13/16	.75	5/8

FIXED

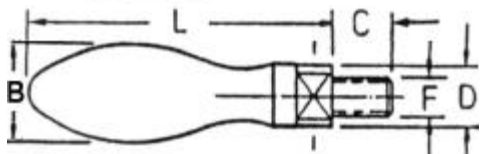

REVOLVING THREADED — STEEL CHROME PLATED HANDLES

**STEEL CHROME HARDENED HIGH POLISHED HANDLES
HIGH STRENGTH AND LONG LASTING**

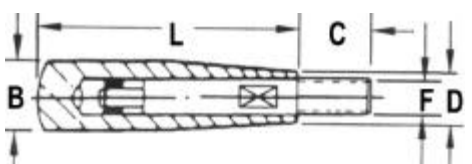

THREADED PART NO.	L	B	C	D	F
UDB-945234	2"	5/8	1/2	15/32	1/4
UDB-945236	2-1/2	3/4	9/16	9/16	5/16
UDB-945238	3-1/4	7/8	5/8	5/8	3/8
UDB-945240	4"	1"	3/4	23/32	1/2

FIXED or PRESS FIT THREADED — ALLOY STEEL CHROME PLATED HANDLES

**ALLOY STEEL CHROME PLATED POLISHED HANDLES
QUALITY DESIGNED TO DO THE JOB**

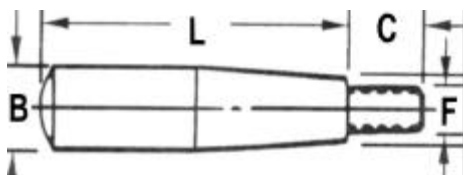

FIXED PART NO.	PRESS FIT PART NO.	L	B	C	D	F
UDB-945242	UDB-945226	2"	1/2	7/16	13/32	1/4-20
UDB-945244	UDB-945228	2-1/2	5/8	9/16	15/32	5/16-18
UDB-945246	UDB-945230	3-1/4	3/4	11/16	19/32	3/8-16
UDB-945248	UDB-945232	4"	1"	13/16	23/32	1/2-13

6-21-02

J14 *Unitized Means High Quality, Functionally Engineered & Competitively Priced!

Balanced Crank Handles

FIXED and SOLID REVOLVING

Crank Handles—Fixed & Solid Revolving

Steel Body – Machined
Polished with Satin Chrome or Bright Chrome Finish
Provided with Fixed Handle

Other inch and bore sizes available on request.

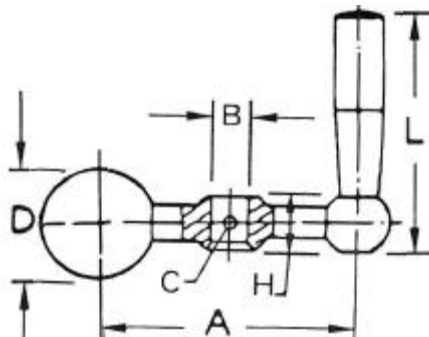

Provided with Fixed Handle.

BALANCED CRANK HANDLE — FIXED



FIXED HANDLE	L	A	B	C	D	H
UDB-945941	2"	2"	5/16	1/8	13/16	7/16
UDB-945942	2-1/2	2-1/2	5/16	1/8	1"	9/16
UDB-945943	3-1/4	3-1/8	3/8	5/32	1-1/4	11/16
UDB-945944	3-1/4	4"	3/8	5/32	1-1/4	11/16
UDB-945945	4"	5"	1/2	3/16	1-1/2	7/8
UDB-945946	4"	6-1/8	1/2	3/16	1-1/2	7/8

UNITED Handles are balanced at the Center. Hole is cross drilled on one wall. Provided with Fixed Modern Design Handle above.

Noted for their design, strength and longevity.

Steel Body — Machined and Highly Polished

Special inch and metric bores larger than those listed and modifications such as keyways, set screw holes and cross holes are available.

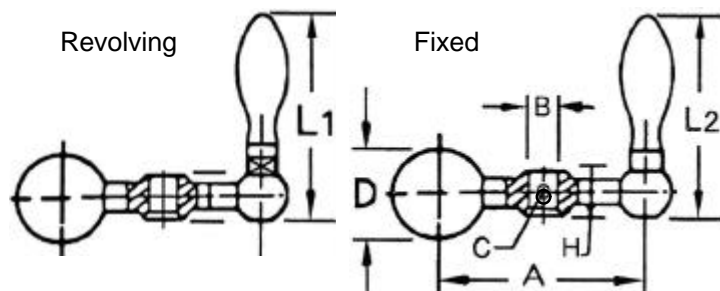

BALANCED CRANK HANDLE — SOLID REVOLVING

Also known as Tri-Ball Handles



Bridgeport Handles

REVOLVING HANDLE	SOLID HANDLE	A	REVOLVING L ₁	FIXED L ₂	B	C	D	H	KEYWAY
UDB-945930	UDB-945935	2-1/2	2-3/4	2-9/16	5/16	1/8	1"	9/16	
UDB-945931	UDB-945936	3-1/8	3-1/2	3-1/4	3/8	5/32	1-1/4	11/16	
UDB-945932	UDB-945937	4"	3-1/2	3-1/4	3/8	5/32	1-1/4	11/16	
UDB-945933	UDB-945938	5"	4-3/16	3-15/16	1/2	3/16	1-1/2	7/8	
* UDB-945934	* UDB-945939	5"	4-3/16	3-15/16	5/8	3/16	1-1/2	7/8	1/8 x 1/16

Balanced at the Center. Hole cross drilled on one wall.

Revolving and Solid Handles have bright polished chrome.

* Replacement handle for Bridgeport Mills

12200 WOODRUFF AVE. DOWNEY, CA 90241-5608 TELEPHONE (562) 803-1521 / (800) 421-3466 IN CA / (800) 486-3466 FAX (562) 803-6898 / (800) 486-3465

4-30-00

EMAIL united@ucc-udb.com WEBSITE www.ucc-udb.com

**Crank Handles – Fold
Away, Forged & Malleable**

Fold Away Retractable, Original Forged and Malleable Crank Handles

FOLD AWAY

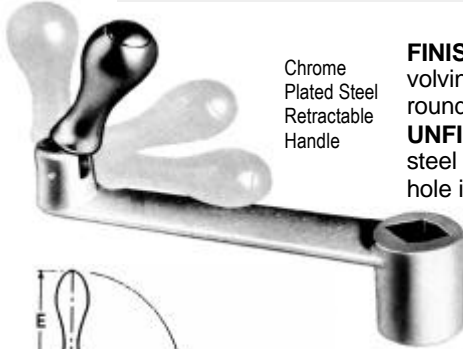

Chrome
Plated Steel
Retractable
Handle

FOLD AWAY CRANK — Finished and Unfinished

FINISHED — Broached, counterbored in free end of hub. Crank finish is gray enamel. Revolving Fold Away Handle is chrome plated steel. Broached openings with corners slightly rounded to prevent breakage.

UNFINISHED — Plain malleable crank. Revolving Fold Away handle is chrome plated steel without hole in the hub.

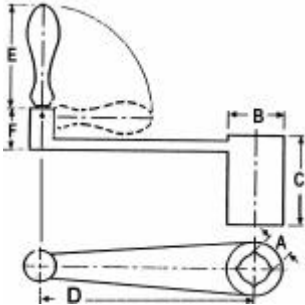

Broached, Plain or
Custom Broached to
Customer specs.

PART NO.	A (SQ.)	DIMENSIONS IN INCHES and (METRIC IN PARENTHESES)				F
		B	C	D	E	
UDB-818221 UNFINISHED		1.31 (33MM)	2.06 (52MM)	5" (127MM)	3.19 (81MM)	1.50 (38MM)
UDB-818222 UNFINISHED		1.31 (33MM)	2.19 (56MM)	6" (152MM)	3.19 (81MM)	1.50 (38MM)
UDB-818223 UNFINISHED		1.44 (37MM)	2.31 (59MM)	7" (178MM)	3.19 (81MM)	1.50 (38MM)
UDB-818224 FINISHED	.625 (15.9MM)	1.31 (33MM)	1.81 (46MM)	5" (127MM)	3.19 (81MM)	1.50 (38MM)
UDB-818225 FINISHED	.688 (17.5MM)	1.31 (33MM)	1.94 (49MM)	6" (152MM)	3.19 (81MM)	1.50 (38MM)
UDB-818226 FINISHED	.750 (19.1MM)	1.44 (37MM)	2.06 (52MM)	7" (178MM)	3.19 (81MM)	1.50 (38MM)

ORIGINAL FORGED CRANK HANDLE



Forged Tough

This one
started your
Grandfather's
Model-T!

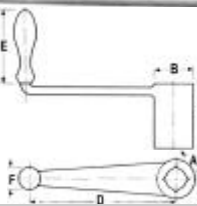

SOLID
Construction

Solid one-piece forged handle for severe usage. Body can be broached or furnished plain for custom fitting or we will do it for you! Material is 1018 Carbon Steel.

FINISHED — Broached, counterbored in free end of hub. Broached openings have rounded corners to prevent breakage. Machine gray finish.

UNFINISHED	BROACHED	FINISHED	DIMENSIONS IN INCHES and (METRIC IN PARENTHESES)					
			A (SQ.)	B	C	D	E	F
UDB-801072	UDB-801082	UDB-801092	.563 (14.3MM)	1.25 (32MM)	1.38 (35MM)	4" (102MM)	3.13 (79MM)	1.00 (25MM)
UDB-801073	UDB-801083	UDB-801093	.625 (15.9MM)	1.25 (32MM)	1.81 (46MM)	5" (127MM)	3.13 (79MM)	1.00 (25MM)
UDB-801075	UDB-801085	UDB-801095	.750 (19.1MM)	1.38 (35MM)	2.06 (52MM)	7" (178MM)	3.38 (86MM)	1.13 (29MM)
UDB-801076	UDB-801086	UDB-801096	.875 (22.3MM)	1.56 (40MM)	2.44 (62MM)	8" (203MM)	3.63 (92MM)	1.13 (29MM)

MALLEABLE CRANK HANDLE

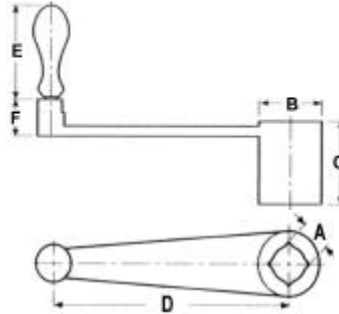

SOLID or REVOLVING

FINISHED — Broached, counterbored in free end of hub. Crank finish is gray enamel.

Revolving Handle is chrome plated steel. Broached openings with corners slightly rounded to prevent breakage.

UNFINISHED — Plain malleable crank. Revolving handle is chrome plated steel without hole in the hub. Material is cast ductile iron.

**CHROME
PLATED HIGH
POLISHED
HANDLES.**

**STRONG
DUCTILE and
SHOCK
RESISTANT.**

**FINISHED and
UNFINISHED.**

REVOLVING UNFINISHED	REVOLVING FINISHED	SOLID UNFINISHED	SOLID FINISHED	FINISHED A (SQ.)	HUB DIA. B	UNFINISHED C	FINISHED C	D	REVOLVING E	SOLID E	F
DIMENSIONS IN INCHES and (METRIC IN PARENTHESES)											
UDB-801064	UDB-801056	UDB-801060	UDB-801068	.563 (14.3MM)	1.31 (33MM)	1.63 (41MM)	1.38 (35MM)	4" (102MM)	2.06 (52MM)	2.13 (54MM)	.81 (21MM)
UDB-801065	UDB-801057	UDB-801061	UDB-801069	.625 (15.9MM)	1.31 (33MM)	2.06 (52MM)	1.81 (46MM)	5" (127MM)	3.03 (77MM)	2.38 (60MM)	.94 (24MM)
UDB-801066	UDB-801058	UDB-801062	UDB-801070	.688 (17.5MM)	1.31 (33MM)	2.19 (56MM)	1.94 (49MM)	6" (152MM)	3.03 (77MM)	2.75 (70MM)	.94 (24MM)
UDB-801067	UDB-801059	UDB-801063	UDB-801071	.750 (19.1MM)	1.44 (37MM)	2.31 (59MM)	2.06 (52MM)	7" (178MM)	3.28 (83MM)	3.22 (82MM)	.94 (24MM)

11-9-98

Speed Ball Balanced Cranks and Iron or Aluminum Handles



Revolving or Solid.
All center balls drilled with 1/4" Pilot Hole.
Machined from solid bar steel and bright polished.

SPEED BALL		Dimensions Inches and (Metric in parentheses)					
SOLID	REVOLVING	A OAL LENGTH	B BALL LARGE	C BALL MEDIUM	D BALL SMALL	E SOLID	E REVOLVING
UDB-954900		3.0 (76MM)	1.00 (25MM)	.88 (22MM)	.63 (16MM)	1.47 (37MM)	
UDB-954902	UDB-954903	3.5 (89MM)	1.13 (29MM)	1.00 (25MM)	.75 (19MM)	1.72 (44MM)	2.06 (52MM)
UDB-954904	UDB-954905	4.0 (102MM)	1.25 (32MM)	1.13 (29MM)	.81 (21MM)	2.00 (51MM)	2.06 (52MM)
UDB-954906	UDB-954907	4.5 (114MM)	1.38 (35MM)	1.25 (32MM)	.94 (24MM)	2.13 (54MM)	2.06 (52MM)
UDB-954908	UDB-954909	5.0 (127MM)	1.50 (38MM)	1.31 (33MM)	1.00 (25MM)	2.38 (60MM)	3.03 (77MM)
UDB-954910	UDB-954911	5.5 (140MM)	1.50 (38MM)	1.31 (33MM)	1.00 (25MM)	2.38 (60MM)	3.03 (77MM)
UDB-954912	UDB-954913	6.0 (152MM)	1.63 (41MM)	1.38 (35MM)	1.00 (25MM)	2.75 (70MM)	3.03 (77MM)
UDB-954914	UDB-954915	6.5 (165MM)	1.63 (41MM)	1.38 (35MM)	1.00 (25MM)	2.75 (70MM)	3.28 (83MM)
UDB-954916	UDB-954917	7".0 (178MM)	1.75 (44MM)	1.44 (37MM)	1.00 (25MM)	3.22 (82MM)	3.28 (83MM)

The Original "Speed Ball" BALANCED CRANK HANDLES

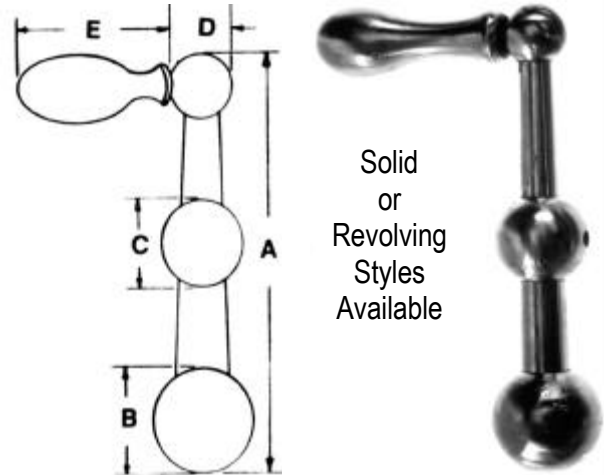

Solid
or
Revolving
Styles
Available

Speed Ball Handles are revolving or solid.
Noted for their Design, Strength and Longevity.

Use **UNITED STRONG IRON** or **ALUMINUM HANDLES**
when high quality and ease of use is required.

Aluminum Alloy Polished Clear Chromate Finish

All Steel Hard Bright Chrome Plated Finish

AVAILABLE In BLACK OXIDE FINISH

Easy Sure Grip Action.

MULTI-USE UNITED HANDLES In MALLEABLE IRON or ALUMINUM

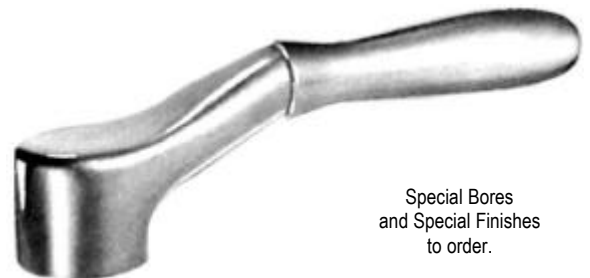

Special Bores
and Special Finishes
to order.

MALLEABLE IRON and ALUMINUM HANDLES								
MALLEABLE IRON	ALUMINUM	A LENGTH	B HUB DIA.	C HEAD HT.	D GRIP LENGTH	E HT. OFFSET	F GRIP DIA.	G HOLE CONDITION
UCC-801620	UCC-801622	4"	1-1/4	7/8	2-1/2	1-1/16	5/8	BLANK
UCC-801624	UCC-801626							.500 REAM
UCC-801628	UCC-801630							.625 REAM
UCC-801632	UCC-801634							1/2-13 TAP
UCC-801636	UCC-801638							5/8-11 TAP
UCC-801640	UCC-801642	5"	1-5/16	1-1/4	3"	1-5/8	3/4	BLANK
UCC-801644	UCC-801646							.625 REAM
UCC-801648	UCC-801650							.750 REAM
UCC-801652	UCC-801654							5/8-11 TAP
UCC-801656	UCC-801658							3/4-10 TAP
UCC-801660	UCC-801662							6"
UCC-801664	UCC-801666	.750 REAM						
UCC-801668	UCC-801670	3/4-10 TAP						

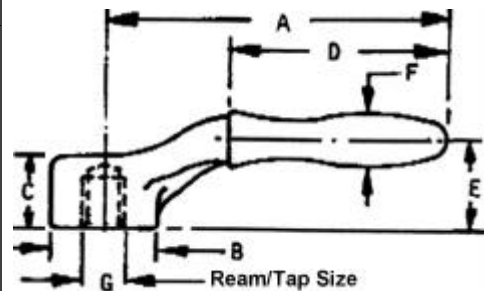

THE HANDLE FOR LIFE!

MULTI-USE HANDLES

Try **UNITED** for the Best!

**Crank Handles —
Revolving & Folding**

Revolving and Folding Crank Handles in Aluminum Die Cast with Black Finish

REVOLVING — Crank Handles

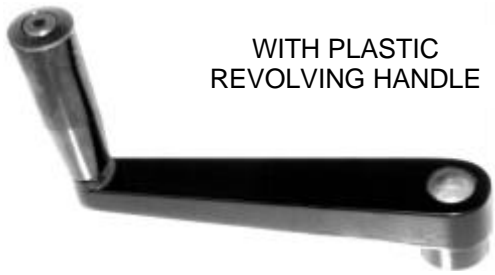

WITH PLASTIC
REVOLVING HANDLE

ECONOMICAL AND PRACTICAL!

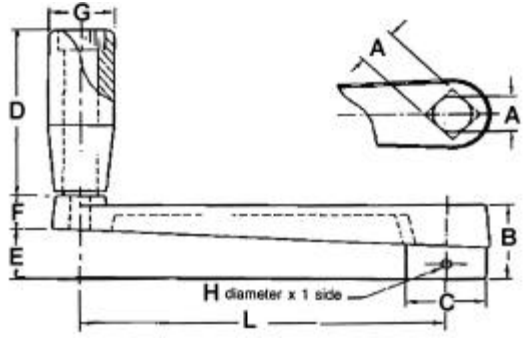

**HIGH QUALITY
ALUMINUM DIE
CAST BODY
WITH BLACK FINISH
PLASTIC HANDLE**

**BORED ROUND
HOLES
OR
BROACHED
SQUARE HOLES
AVAILABLE**

**HIGH
STRENGTH
AND
LONG
LASTING**

BORED Round Hole	BROACHED Square Hole	A Hole Dia	L Length	B Thickness	C O. D.	D Height	E Clearance	F Hub	G Handle Dia	H Dia
UCC-801005	UCC-801005B	5/16	1.20	0.68	0.55	0.94	0.34	0.37	0.56	
UCC-801006	UCC-801006B	3/8	2.52	0.79	0.75	1.22	0.43	0.47	0.70	1/16
UCC-801006A	UCC-801006AB	3/8	3.15	0.95	0.91	1.97	0.55	0.55	0.85	1/16
UCC-801008	UCC-801008B	1/2	3.94	1.10	1.06	2.50	0.67	0.59	0.93	3/32
UCC-801010	UCC-801010B	5/8	4.92	1.34	1.26	3.25	0.87	0.71	1.12	3/32
UCC-801012	UCC-801012B	3/4	6.30	1.50	1.38	3.25	1.02	0.71	1.12	3/32

FOLDABLE REVOLVING Crank Handles — Aluminum Die Cast



WITH PLASTIC
REVOLVING HANDLE

Remains Upright for Operation.

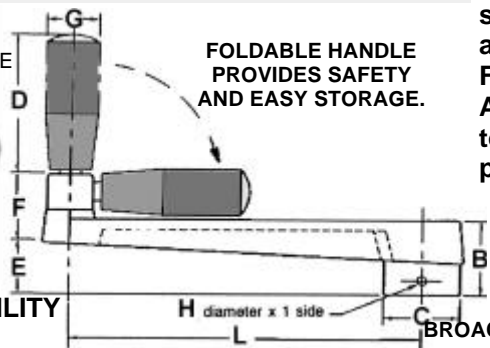

Handle folds away by pulling spring-loaded Handle out and pushing it down. Female thread for attaching. A 3mm Roll Pin is provided to pin down head and prevent head from turning.

**ALUMINUM DIE CAST BODY
WITH SMOOTH FINISH BLACK
PLASTIC FOLDABLE HANDLE.
BORED ROUND HOLES OR
BROACHED SQUARE HOLES AVAILABLE.**

MODERN DESIGN FOR LASTING DURABILITY

**VALUE
AND
QUALITY
DESIGNED
TO DO THE
JOB!**

BORED Round Hole	BROACHED Square Hole	A Hole Dia	L Length	B Thickness	C O. D.	D Height	E Clearance	F Hub	G Handle Dia	H Dia
UCC-801108	UCC-801108B	1/2	3.94	1.10	1.06	2.00	0.67	1.22	0.88	3/32
UCC-801110	UCC-801110B	5/8	4.92	1.34	1.26	2.50	0.87	1.49	0.94	3/32
UCC-801112	UCC-801112B	3/4	6.30	1.50	1.38	3.15	1.02	1.49	1.00	3/32

FOLDABLE REVOLVING HANDLE ONLY — Aluminum Die

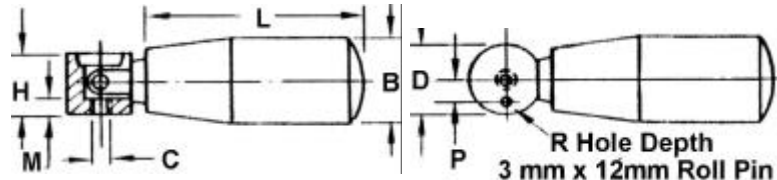

**SMOOTH
FINISH
BLACK
PLASTIC
FOLDABLE
HANDLE**

**MODERN DESIGN
with LASTING
DURABILITY**

HANDLE ONLY	A FITS HOLE	L	B	C	D	H	M	P	R
UCC-801032	1/2	2.00	7/8	10-24	0.630	5/8	5/32	0.197	0.158
UCC-801040	5/8	2.50	15/16	1/4-20	0.780	25/32	7/32	0.276	0.197
UCC-801048	3/4	3.15	1"	1/4-20	0.780	25/32	7/32	0.276	0.197

6-28-99

Cabinet, Lift and Pull Handles

**Cabinet and Pull
Handles from UNITED**

Noted for their modern design, strength and longevity.

UNITED's handsome modern handle has an oval cross-section with a comfortable grip.

Aluminum die casting anodized black smooth finish.
Two blind 1/4" 20 threaded holes for mounting.

OVAL HANDLE	A	C	F	G
UDB-945948	4.50	4.0	1/4-20	0.47
UDB-945949	6.0	5.5	1/4-20	0.47
UDB-945950	8.0	7.5	1/4-20	0.47

You'll want to grab this UNITED Beauty!



OVAL PULL or CABINET HANDLES

Zinc die casting allows easy front mounting.

RECTANGULAR PULL or CABINET HANDLES

Strong, dark, handsome and smooth *United* Handles!

Designed for use with socket head screws or slotted fillister head screws.

If you want some pull, call UNITED!

RECTANGULAR HANDLE	A	B	C	D	E	F	G	H
UDB-945952	3.50	1.42	2.76	0.79	0.79	1/4	0.20	0.24
UDB-945953	4.75	1.58	3.78	1.02	0.87	5/16	0.24	0.28
UDB-945954	7"	1.97	6.22	1.10	0.83	5/16	0.35	0.32

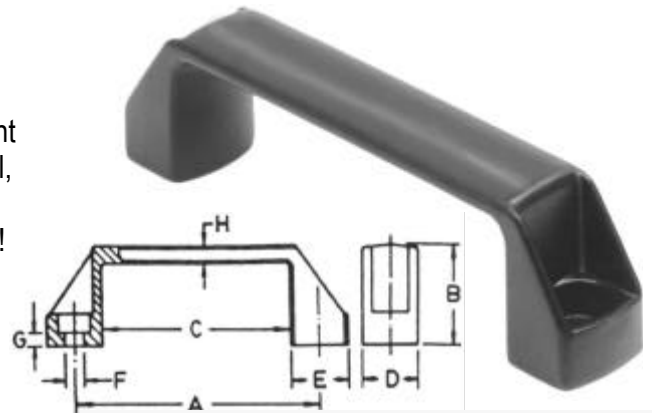

RECTANGULAR CABINET

Ergonomic styling at its best!

This Sure-Grip Handle with clean lines is UNITED's ABS Plastic Standard Handle Model UDB-945956

This Pristine Plastic Handle for Pennies from UNITED!

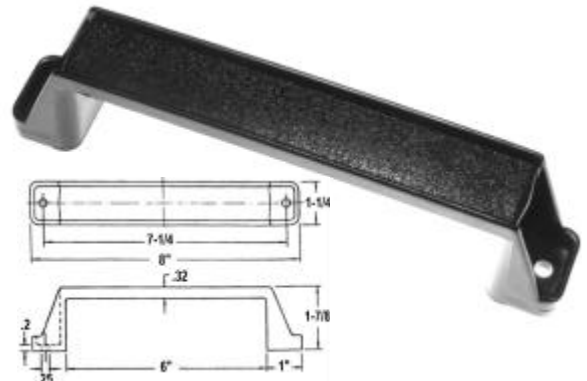

For that special task! Ask for our Tough Aluminum tapped Multi-Pin Electrical Handle.

MULTI-PIN ELECTRICAL HANDLES

MULTI-PIN ELECTRICAL	A	B	C	D	E THD SIZE
UDB-952097	4	1/2	1.848	3/16	2-56-NC-2B
UDB-952098	4	1/2	2.194	5/16	4-40-NC-2B
UDB-952099	4	1/2	1.437	5/16	4-40-NC-2B

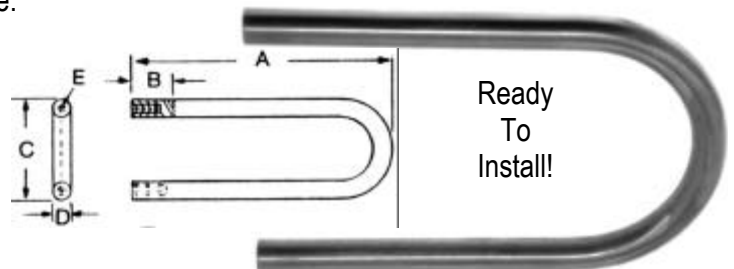

Ready To Install!