

**Kit UDB-756200
For Hi-Lok & Hi-Tigue**

Countersink Flushness Gauge Kit



**UDB-756200 COUNTERSINK
FLUSHNESS GAUGE COMPLETE KIT**



**UDB-756253
BROAD TRIPOD
BASE**

**UDB-756251
DIAL
INDICATOR**

**UDB-756250 GAUGE ASSEMBLY
.0005 WITH BROAD BASE
INDICATOR & STYLUS**

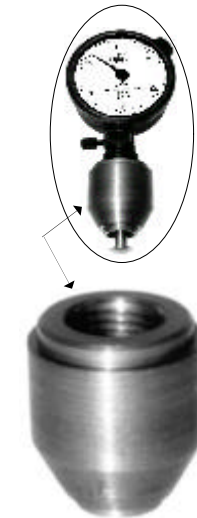

**UDB-756255 NARROW
INDICATOR BASE ONLY**



**HANDLES
(NINE)**

**UDB-10905
HEX KEY
3/32 SHORT**

**UDB-10903
HEX KEY
1/16 LONG**

**GAUGES
(NINE)**

**UNITED KIT
FOR INSPECTION
OF CLOSE
TOLERANCES
ON FLUSH HEAD
FASTENERS**

**UDB-756249 SET OF NINE COUNTERSINK GAUGES FOR
HI-LOK and HI-TIGUE FASTENER HOLES.**

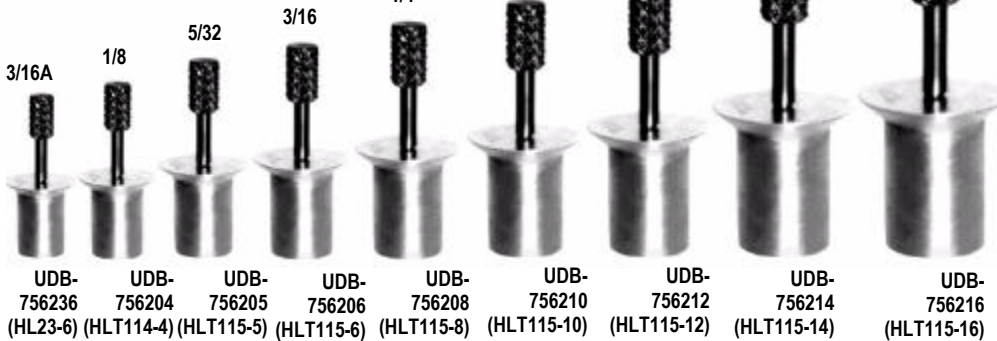

UDB-756236 (HL23-6) **UDB-756204 (HLT114-4)** **UDB-756205 (HLT115-5)** **UDB-756206 (HLT115-6)** **UDB-756208 (HLT115-8)** **UDB-756210 (HLT115-10)** **UDB-756212 (HLT115-12)** **UDB-756214 (HLT115-14)** **UDB-756216 (HLT115-16)**

UDB-756259 CHECK BLOCK

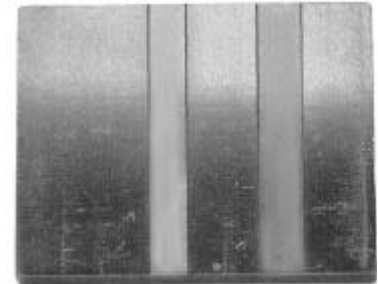

CHECK BLOCK SETS ALL NINE GAUGES

DIAL INDICATOR

Tripod Base has contact points 2-1/4" apart. Base is counterbored 1-1/4 dia.



**UDB-756251
Indicator
Only**

**UDB-756253
Tripod Base
Only**

**PLAIN SPHERICAL STYLUS
ONLY**

DIAL INDICATOR STYLUS

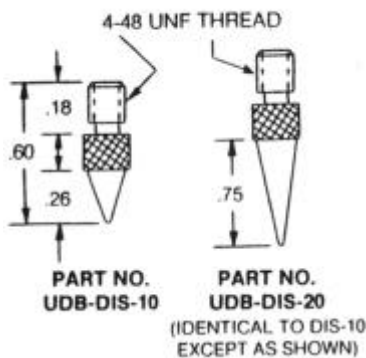

GROUP 1 PART NO.	MINIMUM GRADUATION	TOTAL RANGE
UDB-DI-105	.0001	0.025
UDB-DI-120	.0005	0.075
UDB-DI-135	.001	0.125

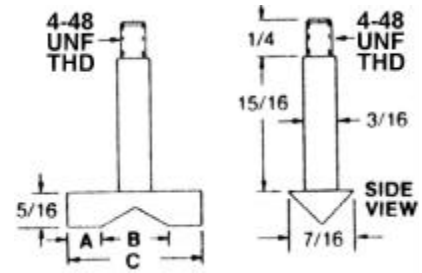
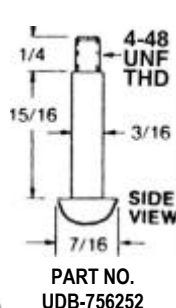

PART NO.	A	B	C
UDB-DIS-30	.047	.095	.190
UDB-DIS-40	.075	.150	.300
UDB-DIS-50	.125	.250	.500
UDB-DIS-60	.200	.400	.800
UDB-DIS-70	.250	.500	1.000

**MEASURES
to .0001
INCH**

Surface Flushness Gauge

Master Gauge Block and Inserts

SIMPLE- FAST - EASY STEPS

1. Adjust Dial Indicator to Zero on Gauge Blocks totaling the Nominal Protrusion Values as specified.
2. Insure proper seating of Fastener into Insert Gauge Bore.
3. Place Stylus on Head of Fastener and/or Gauge Pin. Avoid coming in contact with head markings or any center recess.
4. INSPECT RECORD READINGS!

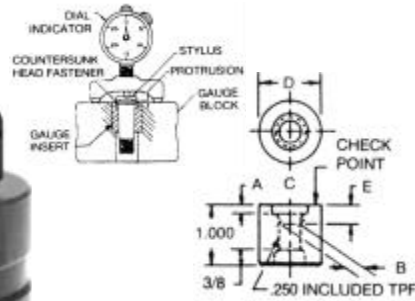

UDB-UTLG-5060 GAUGE INSERTS



SAE 2340 OR 4620 CASE HARDEND .040 DEEP RC 60 MIN.
Gauge Insert O.D.s are 1" - 1-1/2" - 2". Select Master Gauge Blocks with internal dimensions to accommodate Gauge Insert. See bottom of page.

UDB-UTLG-5060	S	-1	-1	-10	P/N Code	INSERT GAUGE
						Nominal Bolt Dia. In 1/16ths
						Bolt Group
						Use (I) Inspection
						Bolt Type: (S) Shear (T) Tension 100°
						Basic GAUGE Number

Close Tolerances on Head Dimensions of Flush Fasteners demand an efficient Inspection Method. **UNITED'S MASTER BLOCKS, INSERT GAUGES and DIAL INDICATORS are EASY to USE, MAINTAIN, and YOU GET a SIMPLE ACCURATE MEASUREMENT!** The Dial Indicator must be capable of measuring .0001 inch, though an Indicator which measures in .0005 inch increments is used and acceptable. The method outlined here was mandated for Inspection of Head Protrusion Values and the Final Acceptance Authority. . Acceptance and Rejection is based on the use of this Inspection Method and primarily on the products on actual Head Protrusion Values. (Refer B.P.S. 253.)

SHEAR GAUGE INSERTS		Cases provided for Sets.						
G #	TENSION DASH NO.	A +.010 -.000	B +.002 -.000	C NOM.	D ±.002	E ±.001	USE STYLUS DASH NO.	GAUGE BLOCK DASH NO.
GROUP 1	S-1-1-3	.065	.199	.2438	1.000	.187	30	1
	S-1-1-4	.080	.261	.3312	1.000	.187	40	1
	S-1-1-5	.085	.325	.4045	1.000	.187	40	1
	S-1-1-6	.100	.389	.4852	1.000	.187	50	1
	S-1-1-7	.110	.454	.5696	1.000	.187	50	1
	S-1-1-8	.115	.519	.6498	1.000	.187	50	1
	S-1-1-9	.125	.593	.7782	1.500	.312	60	2
	S-1-1-10	.145	.660	.8900	1.500	.312	60	2
	S-1-1-12	.176	.790	1.1122	1.500	.312	70	2
	S-1-1-14	.200	.924	1.2894	2.000	.312	70	3
	S-1-1-16	.218	1.056	1.4680	2.000	.312	70	3
	S-1-2-3	.065	.209	.2438	1.000	.187	30	1
S-1-2-4	.080	.274	.3312	1.000	.187	40	1	
S-1-2-5	.085	.339	.4045	1.000	.187	40	1	
S-1-2-6	.100	.404	.4852	1.000	.187	50	1	
S-1-2-7	.110	.472	.5696	1.000	.187	50	1	
S-1-2-8	.115	.539	.6498	1.000	.187	50	1	
S-1-2-9	.125	.624	.7782	1.500	.312	60	2	
S-1-2-10	.145	.693	.8900	1.500	.312	60	2	
S-1-2-12	.176	.829	1.1122	1.500	.312	70	2	
S-1-2-14	.200	.971	1.2894	2.000	.312	70	3	
S-1-2-16	.218	1.107	1.4680	2.000	.312	70	3	
S-1-3-3	.065	.219	.2438	1.000	.187	30	1	
S-1-3-4	.080	.287	.3312	1.000	.187	40	1	
S-1-3-5	.085	.353	.4045	1.000	.187	40	1	
S-1-3-6	.100	.420	.4852	1.000	.187	50	1	
S-1-3-7	.110	.490	.5696	1.000	.187	50	1	
S-1-3-8	.115	.560	.6498	1.000	.187	50	1	
S-1-3-9	.125	.655	.7782	1.500	.312	60	2	
S-1-3-10	.145	.727	.8900	1.500	.312	60	2	
S-1-3-12	.176	.868	1.1122	1.500	.312	70	2	
S-1-3-14	.200	1.017	1.2894	2.000	.312	70	3	
S-1-3-16	.218	1.159	1.4680	2.000	.312	70	3	
S-1-4-4	.080	.300	.3312	1.000	.187	40	1	
S-1-4-5	.085	.368	.4045	1.000	.187	40	1	
S-1-4-6	.100	.435	.4852	1.000	.187	50	1	
S-1-4-7	.110	.508	.5696	1.000	.187	50	1	
S-1-4-8	.115	.581	.6498	1.000	.187	50	1	
S-1-4-9	.125	.686	.7782	1.500	.312	60	2	
S-1-4-10	.145	.759	.8900	1.500	.312	60	2	
S-1-4-12	.176	.907	1.1122	1.500	.312	70	2	
S-1-4-14	.200	1.064	1.2894	2.000	.312	70	3	
S-1-4-16	.218	1.211	1.4680	2.000	.312	70	3	

TENSION GAUGE INSERTS		Cases provided for Sets.						
G #	TENSION DASH NO.	A +.010 -.000	B +.002 -.000	C NOM.	D ±.002	E ±.001	USE STYLUS DASH NO.	GAUGE BLOCK DASH NO.
GROUP 1	T-1-1-3	.080	.199	.3270	1.000	.187	40	1
	T-1-1-4	.105	.261	.4318	1.000	.187	40	1
	T-1-1-5	.140	.324	.5449	1.000	.187	50	1
	T-1-1-6	.160	.389	.6580	1.000	.187	50	1
	T-1-1-7	.165	.454	.7782	1.000	.187	50	1
	T-1-1-8	.180	.519	.8900	1.000	.187	60	1
	T-1-1-9	.220	.595	1.0026	1.500	.312	60	2
	T-1-1-10	.240	.661	1.1122	1.500	.312	70	2
	T-1-1-12	.255	.792	1.2894	1.500	.312	70	2
	T-1-1-14	.275	.926	1.4680	2.000	.312	70	3
	T-1-1-16	.275	1.056	1.5730	2.000	.312	70	3
	T-1-2-3	.080	.210	.3270	1.000	.187	40	1
T-1-2-4	.105	.275	.4318	1.000	.187	40	1	
T-1-2-5	.140	.340	.5449	1.000	.187	50	1	
T-1-2-6	.160	.406	.6580	1.000	.187	50	1	
T-1-2-7	.165	.474	.7782	1.000	.187	50	1	
T-1-2-8	.180	.542	.8900	1.000	.187	60	1	
T-1-2-9	.220	.626	1.0026	1.500	.312	60	2	
T-1-2-10	.240	.694	1.1122	1.500	.312	70	2	
T-1-2-12	.255	.831	1.2894	1.500	.312	70	2	
T-1-2-14	.275	.972	1.4680	2.000	.312	70	3	
T-1-2-16	.275	1.108	1.5730	2.000	.312	70	3	
T-1-3-3	.080	.220	.3270	1.000	.187	40	1	
T-1-3-4	.105	.288	.4318	1.000	.187	40	1	
T-1-3-5	.140	.355	.5449	1.000	.187	50	1	
T-1-3-6	.160	.421	.6580	1.000	.187	50	1	
T-1-3-7	.165	.492	.7782	1.000	.187	50	1	
T-1-3-8	.180	.562	.8900	1.000	.187	60	1	
T-1-3-9	.220	.657	1.0026	1.500	.312	60	2	
T-1-3-10	.240	.728	1.1122	1.500	.312	70	2	
T-1-3-12	.255	.869	1.2894	1.500	.312	70	2	
T-1-3-14	.275	1.019	1.4680	2.000	.312	70	3	
T-1-3-16	.275	1.160	1.5730	2.000	.312	70	3	
T-1-4-4	.105	.301	.4318	1.000	.187	40	1	
T-1-4-5	.140	.369	.5449	1.000	.187	50	1	
T-1-4-6	.160	.437	.6580	1.000	.187	50	1	
T-1-4-7	.165	.510	.7782	1.000	.187	50	1	
T-1-4-8	.180	.583	.8900	1.000	.187	60	1	
T-1-4-9	.220	.688	1.0026	1.500	.312	60	2	
T-1-4-10	.240	.761	1.1122	1.500	.312	70	2	
T-1-4-12	.255	.908	1.2894	1.500	.312	70	2	
T-1-4-14	.275	1.065	1.4680	2.000	.312	70	3	
T-1-4-16	.275	1.211	1.5730	2.000	.312	70	3	

NOTE: 'C' Dimensions on UNITED GAUGES are .0020 below the specified dimensions to allow for wear.

GAUGE BLOCK MASTER PART NO.	D DIA. +.010 -.000
UTLG-5060-1	1.000
UTLG-5060-2	1.500
UTLG-5060-3	2.000
UTLG-5060-123	SET OF THREE ABOVE PROVIDED IN A CASE.

Select Gauge Blocks with internal dimensions to accommodate Gauge Insert.

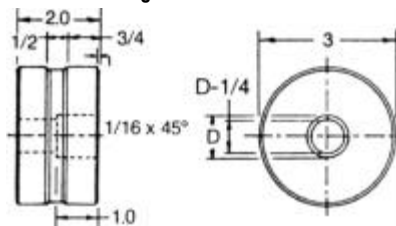

UDB-UTLG-5060 GAUGE BLOCK MASTERS

GAUGE BLOCK
SAE D2 STEEL RC 62-64



Tapered Laps

Lap to Finish Excellence

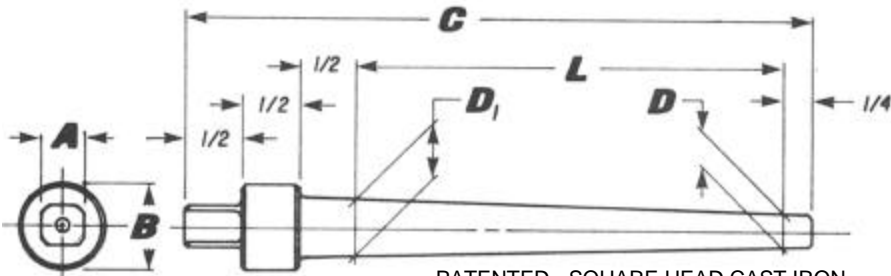
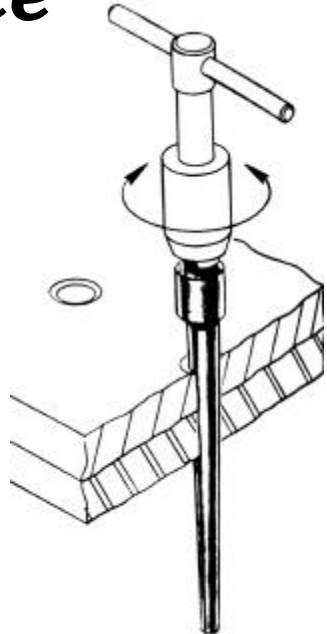

PATENTED - SQUARE HEAD CAST IRON
.2500 ±.001 INCLUDED TAPER PER FOOT

LAP FOR A FINE FINISH IN TAPERED HOLES!

Even deep holes in high tensile material lap to an excellent finish. After lapping recheck the hole with *UNITED*'s Taper Hole Gauge to see that the hole is on size. Always clean hole thoroughly after lapping and before gauging. *UNITED* will regrind worn Taper Laps. Prices on quotation.

Use **UNITED LAPPING TOOLS** For Excellence of Finish!

UNITED PART NO.	TAPER LOCK		DIMENSIONS						
	SIZE	AND GROUP	A	B	C	D	D ₁	L	
UDB-601500	5/32	GROUP 1 - 5	1/4	3/8	3.72	.163	.204	1.971	
UDB-601501	3/16	GROUP 1 - 5	1/4	3/8	4.29	.189	.242	2.543	
UDB-601502	1/4	GROUP 1 - 5	1/4	3/8	4.96	.248	.315	3.215	
UDB-601503	5/16	GROUP 1 - 5	1/4	3/8	5.25	.310	.383	3.503	
UDB-601504	3/8	GROUP 1 - 4	3/8	1/2	4.82	.372	.436	3.071	
UDB-601505	3/8	GROUP 5	3/8	1/2	4.05	.404	.452	2.303	
UDB-601506	7/16	GROUP 1 - 4	3/8	1/2	5.35	.434	.509	3.599	
UDB-601507	7/16	GROUP 5	3/8	1/2	4.44	.471	.527	2.687	
UDB-601508	1/2	GROUP 1 - 4	1/2	3/4	5.88	.496	.582	4.127	
UDB-601509	1/2	GROUP 5	1/2	3/4	4.82	.538	.602	3.071	
UDB-601510	9/16	GROUP 1 - 3	1/2	3/4	6.40	.559	.656	4.655	
UDB-601511	9/16	GROUP 4	1/2	3/4	6.40	.590	.687	4.655	
UDB-601512	9/16	GROUP 5	1/2	3/4	6.40	.621	.718	4.655	
UDB-601513	5/8	GROUP 1 - 3	5/8	7/8	6.79	.621	.726	5.039	
UDB-601514	5/8	GROUP 4	5/8	7/8	6.79	.655	.760	5.039	
UDB-601515	5/8	GROUP 5	5/8	7/8	6.79	.688	.793	5.039	
UDB-601516	3/4	GROUP 1 - 3	5/8	7/8	7.51	.746	.866	5.758	
UDB-601517	3/4	GROUP 4	5/8	7/8	7.51	.786	.906	5.758	
UDB-601518	3/4	GROUP 5	5/8	7/8	7.51	.825	.945	5.758	
UDB-601519	7/8	GROUP 1 - 3	5/8	1-1/4	8.45	.875	1.014	6.700	
UDB-601520	7/8	GROUP 4	5/8	1-1/4	6.25	.968	1.061	4.500	
UDB-601521	7/8	GROUP 5	5/8	1-1/4	8.45	.968	1.108	6.700	
UDB-601522	1"	GROUP 1 - 3	5/8	1-3/8	8.45	1.003	1.143	6.700	
UDB-601523	1"	GROUP 4	5/8	1-3/8	6.75	1.110	1.214	5.000	
UDB-601524	1"	GROUP 5	5/8	1-3/8	9.25	1.110	1.266	7.500	

Taper Lock Rivet Sets

TL Rivet Sets

FASTENER RIVET SET

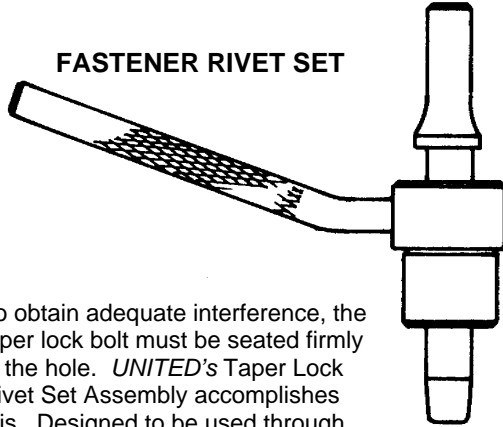

To obtain adequate interference, the taper lock bolt must be seated firmly in the hole. UNITED's Taper Lock Rivet Set Assembly accomplishes this. Designed to be used through the SHELOX Liner. This Set will easily adapt to most pneumatic rivet guns and will secure them before the nut is torqued.

UNITED TAPER LOCK RIVET SET ASSEMBLIES

ASSEMBLY PART NO.	TAPER LOCK BOLT SIZE	FITS SHELOX
UDB-755444	1/4	521154 OR 521354
UDB-755445	5/16	521155 OR 521355
UDB-755446	3/8	521156 OR 521356
UDB-755447	7/16	521157 OR 521357
UDB-755448	1/2	521158 OR 521358
UDB-755449	9/16	521158 OR 521358
UDB-755450	5/8	521160 OR 521360

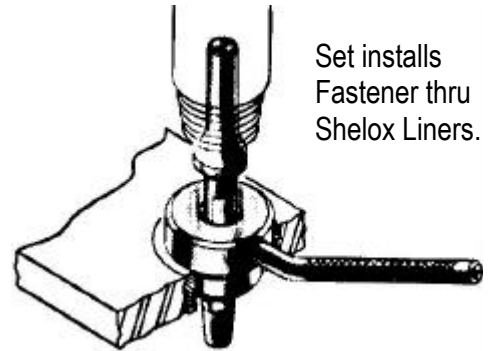

Set installs Fastener thru Shelox Liners.



FASTENER GUIDE HANDLE ONLY

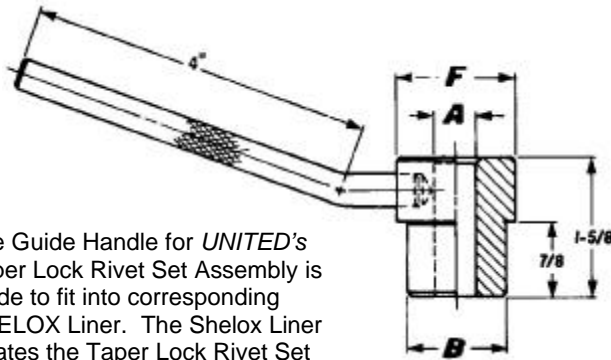

The Guide Handle for UNITED's Taper Lock Rivet Set Assembly is made to fit into corresponding SHELOX Liner. The Shelox Liner locates the Taper Lock Rivet Set precisely over the Head of the Fastener, then drives it squarely into place.

HANDLE PART NO.	TAPER LOCK BOLT SIZE	A	B	F	FITS SHELOX
UDB-755484	1/4	$\frac{.4685}{.4695}$	$\frac{1.040}{1.039}$	1-1/2	521154 OR 521354
UDB-755485	5/16	$\frac{.4685}{.4695}$	$\frac{1.167}{1.166}$	1-17/32	521155 OR 521355
UDB-755486	3/8	$\frac{.4685}{.4695}$	$\frac{1.395}{1.394}$	1-3/4	521156 OR 521356
UDB-755487	7/16	$\frac{.5625}{.5635}$	$\frac{1.604}{1.603}$	1-15/16	521157 OR 521357
UDB-755488	1/2	$\frac{.6405}{.6415}$	$\frac{1.816}{1.815}$	2-3/16	521158 OR 521358
UDB-755489	9/16	$\frac{.7815}{.7825}$	$\frac{2.085}{2.084}$	2-7/16	521158 OR 521358
UDB-755490	5/8	$\frac{.8755}{.8765}$	$\frac{2.295}{2.294}$	2-21/32	521160 OR 521360

ANVIL ONLY

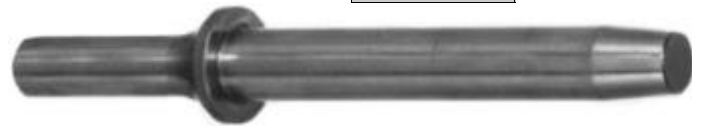

Taper Only on: UDB-755464 and UDB-755465.

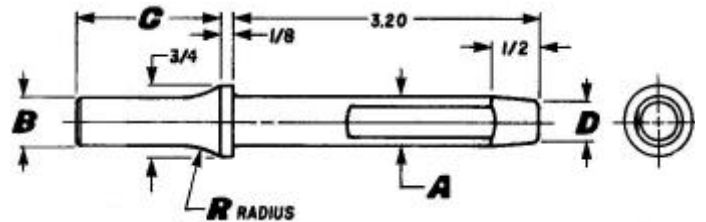

UNITED's Taper Lock Rivet Sets are manufactured from tough alloy steel selected to resist fracturing.

Sets can be used until shortened by .187 at which time they must be replaced.

ANVIL PART NO.	FITS HANDLE	A	B	C	D	R
UDB-755464	UDB-755484	$\frac{.4680}{.4670}$	$\frac{.402}{.400}$	1.53	.300 TAPERED	1/2
UDB-755465	UDB-755485	$\frac{.4680}{.4670}$	$\frac{.402}{.400}$	1.53	.384 TAPERED	1/2
UDB-755466	UDB-755486	$\frac{.4680}{.4670}$	$\frac{.402}{.400}$	1.53	.468	1/2
UDB-755467	UDB-755487	$\frac{.5620}{.5610}$	$\frac{.498}{.496}$	1.50	.562	3/4
UDB-755468	UDB-755488	$\frac{.6400}{.6390}$	$\frac{.498}{.496}$	1.50	.640	3/4
UDB-755469	UDB-755489	$\frac{.7810}{.7800}$	$\frac{.498}{.496}$	1.50	.781	3/4
UDB-755470	UDB-755490	$\frac{.8750}{.8740}$	$\frac{.498}{.496}$	1.50	.875	3/4

**'Go'-'No Go'
Plug Gauges**

Uni-Check Cylindrical Plug Gauges-'Go-No Go'

CYLINDRICAL PLUG GAUGES—'GO' and 'NO GO'

DIMENSIONS CONTINUE ON
PAGES S29 AND S30.

UDB-862320 (plus Dash No.)

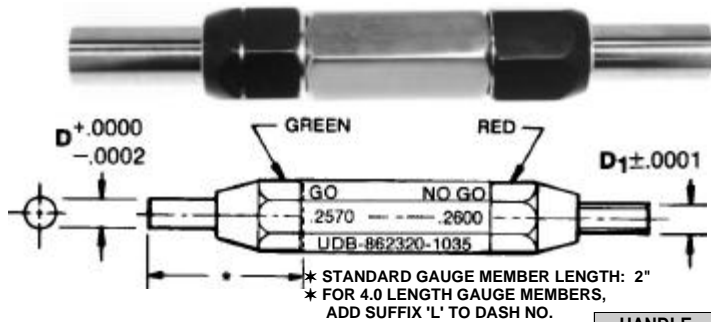

To order, specify Part No. plus Dash No.
Example: UDB-862320—1035

GAUGES ARE
AVAILABLE IN .001
INCREMENTS.

ADDITIONAL GAUGE MEMBERS ARE AVAILABLE WITH THE FOLLOWING TOLERANCES:	1	+ .0000 - .0002
	2	+ .0002 - .0000
	3	+ .0001 - .0001

Special
NO-GO
Designs

VIEWS
ENLARGED

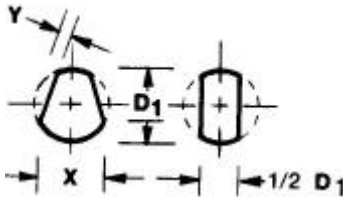

**RELIEVED
STYLE**

**BLADE
STYLE**

(SPECIAL)

(SPECIAL)

**STANDARD 'NO GO' DESIGN
ADD SUFFIX 'R' TO DASH NO.**

**'NO GO' DESIGN UP TO .760
ADD SUFFIX 'B' TO DASH NO.**

SPECIAL SIZES available on request.
GAUGE SETS are available on request.

HANDLE PART NO.	BUSHING PART NO. (ADD DASH NO.)	GAUGE RANGE			HEX	LENGTH
		MIN	THRU	MAX		
UDB-862321H	UDB-862321B (PLUS DASH NO.)	.061	THRU	.075	1/4	2"
UDB-862322H	UDB-862322B- (PLUS DASH NO.)	.075	THRU	.180	3/8	2-1/2
UDB-862323H	UDB-862323B- (PLUS DASH NO.)	.181	THRU	.281	9/16	3"
UDB-862324H	UDB-862324B- (PLUS DASH NO.)	.282	THRU	.406	11/16	3-1/2
UDB-862325H	UDB-862325B- (PLUS DASH NO.)	.407	THRU	.510	13/16	4"
UDB-862326H	UDB-862326B- (PLUS DASH NO.)	.511	THRU	.635	15/16	4-17/32
UDB-862327H	UDB-862327B- (PLUS DASH NO.)	.636	THRU	.760	1-1/16	4-21/32
UDB-862328H	'TRI-LOK' TYPE	.761	THRU	1.010	1-1/4	5-1/4
UDB-862329H	'TRI-LOK' TYPE	1.011	THRU	1.5015	1-1/4	5-1/4

DASH NO.	D DIA.	D ₁ DIA.	DASH NO.	D DIA.	D ₁ DIA.	DASH NO.	D DIA.	D ₁ DIA.	DASH NO.	D DIA.	D ₁ DIA.
0200	.0940	.1010	0320	.1370	.1410	0430	.1700	.1730	0520	.1890	.1930
0205	.0960	.1030	0325	.1440	.1470	0435	.1710	.1730	0525	.1895	.1905
0210	.0970	.1040	0330	.1440	.1500	0440	.1710	.1740	0530	.1895	.1912
0215	.0980	.1020	0335	.1450	.1500	0445	.1720	.1750	0535	.1895	.1915
0220	.0980	.1030	0340	.1540	.1560	0450	.1760	.1790	0540	.1895	.1920
0225	.0980	.1060	0345	.1540	.1570	0453	.1770	.1787	0545	.1900	.1920
0230	.0980	.1120	0350	.1590	.1610	0455	.1770	.1810	0550	.1900	.1922
0235	.0990	.1060	0355	.1590	.1620	0457	.1770	.1820	0555	.1900	.1930
0240	.1040	.1110	0360	.1590	.1650	0460	.1800	.1820	0560	.1900	.1940
0245	.1070	.1140	0365	.1590	.1720	0462	.1800	.1830	0565	.1900	.1960
0250	.1090	.1160	0370	.1600	.1640	0465	.1820	.1840	0570	.1900	.1980
0255	.1110	.1180	0375	.1605	.1625	0470	.1830	.1850	0575	.1904	.1914
0260	.1140	.1210	0380	.1610	.1620	0475	.1850	.1870	0580	.1905	.1925
0265	.1180	.1250	0385	.1610	.1635	0480	.1850	.1880	0585	.1910	.1940
0270	.1230	.1260	0390	.1610	.1660	0482	.1860	.1865	0590	.1910	.1970
0275	.1245	.1265	0392	.1615	.1635	0483	.1860	.1880	0595	.1920	.1960
0280	.1245	.1270	0394	.1635	.1652	0485	.1865	.1875	0600	.1920	.1980
0285	.1250	.1300	0395	.1635	.1657	0490	.1865	.1885	0605	.1930	.1950
0290	.1270	.1290	0400	.1640	.1662	0493	.1870	.1890	0610	.1930	.1970
0295	.1280	.1320	0405	.1640	.1680	0495	.1875	.1897	0615	.1950	.1970
0300	.1280	.1420	0410	.1645	.1675	0500	.1875	.1905	0620	.1955	.1965
0305	.1285	.1320	0415	.1650	.1670	0505	.1880	.1890	0625	.1955	.1975
0310	.1285	.1340	0420	.1650	.1680	0510	.1880	.1910	0630	.1955	.2025
0315	.1290	.1320	0425	.1660	.1720	0515	.1890	.1920	0635	.1960	.1970

CONTINUED ON PAGES S29 AND S30 . . .

Uni-Check Cylindrical Plug Gauges-'Go-No Go'



DIMENSIONS CONTINUE ON PAGE S30. SEE PAGE S28.

DASH NO.	D DIA.	D ₁ DIA.	DASH NO.	D DIA.	D ₁ DIA.	DASH NO.	D DIA.	D ₁ DIA.	DASH NO.	D DIA.	D ₁ DIA.
0640	.1960	.1990	0891	.2460	.2480	1175	.2765	.2785	1450	.3235	.3255
0645	.1970	.2010	0895	.2460	.2600	1180	.2770	.2780	1455	.3240	.3250
0650	.1975	.1995	0900	.2470	.2480	1181	.2770	.2790	1460	.3245	.3265
0655	.1985	.2005	0905	.2470	.2490	1185	.2775	.2795	1465	.3255	.3275
0659	.1990	.2010	0910	.2475	.2485	1190	.2780	.2790	1470	.3270	.3290
0665	.1995	.2015	0915	.2475	.2505	1191	.2780	.2800	1475	.3275	.3285
0670	.2000	.2020	0920	.2480	.2500	1195	.2785	.2795	1480	.3275	.3295
0675	.2005	.2025	0925	.2480	.2510	1200	.2785	.2805	1485	.3276	.3293
0680	.2010	.2040	0930	.2490	.2500	1205	.2795	.2825	1489	.3280	.3297
0685	.2020	.2040	0935	.2490	.2580	1210	.2800	.2850	1490	.3280	.3320
0690	.2025	.2035	0940	.2495	.2505	1215	.2805	.2815	1495	.3280	.3340
0695	.2025	.2045	0945	.2495	.2512	1220	.2805	.2825	1500	.3281	.3303
0697	.2026	.2043	0950	.2495	.2515	1222	.2807	.2824	1502	.3291	.3308
0700	.2030	.2070	0955	.2495	.2520	1225	.2808	.2825	1505	.3320	.3360
0705	.2040	.2080	0960	.2495	.2525	1230	.2810	.2830	1510	.3320	.3380
0707	.2041	.2058	0964	.2500	.2517	1235	.2810	.2850	1515	.3360	.3380
0710	.2050	.2060	0965	.2500	.2522	1240	.2810	.2870	1520	.3365	.3375
0715	.2050	.2090	0970	.2500	.2530	1245	.2812	.2834	1525	.3380	.3390
0720	.2051	.2068	0975	.2500	.2540	1247	.2822	.2839	1530	.3380	.3400
0725	.2055	.2075	0980	.2500	.2560	1250	.2830	.2850	1535	.3390	.3410
0727	.2055	.2095	0985	.2502	.2512	1255	.2850	.2870	1540	.3390	.3450
0730	.2056	.2078	0990	.2515	.2535	1260	.2860	.2910	1545	.3400	.3410
0735	.2105	.2125	0995	.2530	.2560	1265	.2885	.2905	1550	.3400	.3420
0740	.2110	.2120	1000	.2540	.2560	1270	.2890	.2950	1555	.3415	.3435
0745	.2120	.2130	1005	.2550	.2620	1275	.2900	.2910	1560	.3420	.3440
0750	.2130	.2150	1010	.2550	.2630	1280	.2910	.2930	1565	.3430	.3440
0755	.2140	.2160	1015	.2560	.2610	1285	.2930	.2950	1570	.3430	.3450
0757	.2145	.2160	1020	.2565	.2585	1290	.2940	.2960	1572	.3432	.3444
0760	.2150	.2160	1025	.2570	.2580	1295	.2940	.3000	1575	.3433	.3450
0765	.2150	.2170	1030	.2570	.2590	1300	.2950	.2990	1580	.3435	.3455
0767	.2150	.2180	1035	.2570	.2600	1305	.2965	.2985	1585	.3435	.3475
0769	.2152	.2196	1040	.2570	.2610	1310	.3050	.3070	1590	.3437	.3459
0770	.2155	.2175	1045	.2570	.2630	1315	.3065	.3085	1595	.3440	.3470
0775	.2160	.2180	1050	.2575	.2695	1320	.3070	.3090	1600	.3515	.3535
0780	.2165	.2195	1055	.2580	.2640	1325	.3075	.3095	1605	.3535	.3555
0785	.2180	.2190	1060	.2585	.2595	1330	.3075	.3105	1610	.3555	.3575
0790	.2180	.2200	1065	.2595	.2615	1335	.3080	.3105	1615	.3570	.3590
0792	.2182	.2199	1070	.2600	.2620	1337	.3085	.3105	1620	.3590	.3610
0795	.2185	.2205	1075	.2600	.2630	1340	.3090	.3100	1625	.3665	.3685
0800	.2185	.2225	1080	.2610	.2620	1345	.3090	.3110	1630	.3670	.3690
0805	.2190	.2220	1085	.2610	.2630	1350	.3110	.3130	1635	.3680	.3700
0810	.2190	.2230	1087	.2615	.2635	1355	.3115	.3145	1640	.3690	.3710
0812	.2197	.2214	1090	.2620	.2640	1360	.3120	.3130	1645	.3700	.3720
0815	.2208	.2225	1095	.2625	.2635	1365	.3120	.3137	1650	.3700	.3730
0820	.2210	.2240	1100	.2625	.2645	1370	.3120	.3140	1655	.3710	.3720
0822	.2210	.2250	1105	.2630	.2640	1375	.3120	.3142	1660	.3710	.3730
0825	.2210	.2260	1110	.2640	.2670	1380	.3120	.3150	1665	.3730	.3750
0830	.2212	.2234	1115	.2645	.2665	1385	.3120	.3160	1670	.3740	.3760
0835	.2240	.2290	1120	.2650	.2660	1390	.3125	.3147	1675	.3745	.3755
0840	.2260	.2280	1125	.2650	.2670	1395	.3125	.3155	1680	.3745	.3762
0845	.2285	.2305	1130	.2651	.2668	1400	.3125	.3165	1685	.3745	.3765
0850	.2305	.2325	1131	.2651	.2671	1402	.3127	.3144	1690	.3745	.3767
0855	.2315	.2335	1135	.2655	.2695	1405	.3130	.3190	1695	.3745	.3785
0860	.2340	.2360	1140	.2656	.2678	1410	.3150	.3180	1700	.3750	.3772
0865	.2420	.2440	1145	.2730	.2750	1415	.3160	.3230	1705	.3750	.3780
0870	.2425	.2445	1150	.2740	.2750	1420	.3170	.3220	1710	.3750	.3790
0875	.2440	.2460	1155	.2740	.2760	1425	.3170	.3230	1715	.3780	.3810
0880	.2450	.2470	1160	.2745	.2765	1430	.3205	.3225	1720	.3800	.3850
0885	.2450	.2480	1165	.2755	.2775	1435	.3210	.3220	1725	.3800	.3870
0890	.2460	.2470	1170	.2760	.2780	1440	.3225	.3245	1730	.3820	.3840
			1171	.2760	.2790	1445	.3230	.3270	1735	.3825	.3835

12200 WOODRUFF AVE. DOWNEY, CA 90241-5608 TELEPHONE (562) 803-1521 / (800) 421-3466 IN CA / (800) 486-3466 FAX (562) 803-6898 / (800) 486-3465

**'Go'-'No Go'
Plug Gauges**

Uni-Check Cylindrical Plug Gauges-'Go-No Go'

CYLINDRICAL PLUG GAUGES—'GO' and 'NO GO'

UDB-862320 (plus Dash No.)

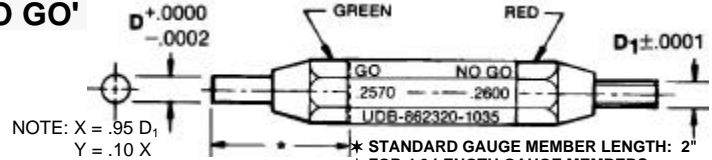

NOTE: $X = .95 D_1$
 $Y = .10 X$

MORE DIMENSIONS ON PAGES S28 AND S29.

* STANDARD GAUGE MEMBER LENGTH: 2"
* FOR 4.0 LENGTH GAUGE MEMBERS,
ADD SUFFIX 'L' TO DASH NO.

DASH NO.	D DIA.	D ₁ DIA.	DASH NO.	D DIA.	D ₁ DIA.	DASH NO.	D DIA.	D ₁ DIA.	DASH NO.	D DIA.	D ₁ DIA.
1740	.3830	.3850	1970	.4375	.4405	2200	.5180	.5200	2432	.6280	.6300
1745	.3835	.3855	1975	.4375	.4425	2205	.5220	.5240	2435	.6375	.6395
1750	.3840	.3860	1980	.4460	.4480	2210	.5235	.5255	2440	.6400	.6420
1755	.3850	.3870	1985	.4485	.4505	2215	.5265	.5285	2445	.6401	.6423
1760	.3860	.3880	1990	.4490	.4500	2220	.5275	.5295	2450	.6405	.6455
1765	.3860	.3890	1995	.4490	.4510	2225	.5280	.5300	2455	.6540	.6560
1770	.3860	.3900	2000	.4495	.4515	2230	.5290	.5305	2460	.6555	.6575
1775	.3865	.3885	2005	.4505	.4525	2235	.5290	.5310	2465	.6557	.6579
1780	.3870	.3890	2010	.4525	.4535	2240	.5305	.5325	2470	.6560	.6610
1785	.3885	.3905	2015	.4525	.4545	2245	.5310	.5330	2475	.6850	.6900
1790	.3900	.3910	2019	.4530	.4570	2250	.5310	.5360	2480	.7470	.7480
1795	.3900	.3920	2020	.4530	.4580	2255	.5310	.5390	2485	.7495	.7505
1797	.3901	.3918	2025	.4531	.4553	2260	.5312	.5334	2490	.7495	.7515
1800	.3905	.3945	2030	.4615	.4635	2265	.5320	.5340	2495	.7495	.7517
1805	.3906	.3928	2035	.4640	.4660	2270	.5390	.5410	2500	.7505	.7515
1810	.3910	.3970	2040	.4650	.4660	2275	.5420	.5440	2505	.7651	.7673
1815	.3975	.3995	2045	.4650	.4670	2280	.5430	.5450	2507	.7660	.7730
1820	.3980	.3990	2050	.4665	.4685	2285	.5435	.5455	2510	.7807	.7829
1825	.4000	.4020	2055	.4680	.4690	2290	.5460	.5510	2515	.8070	.8090
1830	.4005	.4025	2060	.4680	.4700	2295	.5465	.5485	2520	.8120	.8130
1835	.4015	.4035	2065	.4685	.4705	2300	.5600	.5620	2525	.8710	.8720
1840	.4020	.4030	2070	.4685	.4735	2305	.5610	.5630	2530	.8730	.8780
1845	.4025	.4045	2075	.4687	.4709	2310	.5620	.5630	2534	.8745	.8755
1850	.4030	.4050	2080	.4690	.4770	2315	.5620	.5640	2535	.8745	.8765
1855	.4055	.4065	2085	.4770	.4790	2320	.5620	.5642	2540	.8745	.8767
1860	.4055	.4075	2090	.4795	.4815	2325	.5625	.5647	2545	.8890	.8910
1865	.4057	.4067	2095	.4805	.4825	2330	.5625	.5675	2550	.8901	.8923
1866	.4057	.4074	2100	.4839	.4849	2332	.5655	.5675	2555	.8910	.8980
1870	.4060	.4080	2105	.4840	.4860	2335	.5750	.5770	2560	.9057	.9079
1875	.4060	.4100	2110	.4950	.4970	2340	.5755	.5775	2565	.9335	.9345
1880	.4072	.4084	2115	.4950	.4980	2345	.5775	.5795	2570	.9370	.9380
1885	.4130	.4150	2120	.4960	.4970	2350	.5776	.5798	2575	.9660	.9710
1890	.4130	.4180	2125	.4960	.4980	2355	.5780	.5830	2580	.9980	.9990
1895	.4160	.4180	2130	.4985	.5005	2360	.5820	.5840	2582	.9990	.9995
1900	.4180	.4200	2135	.4995	.5005	2365	.5840	.5860	2585	.9995	1.0017
1905	.4185	.4205	2140	.4995	.5015	2370	.5910	.5930	2590	1.0000	1.0020
1910	.4200	.4210	2145	.4995	.5027	2375	.5910	.5960	2595	1.0000	1.0030
1915	.4215	.4235	2150	.5000	.5022	2380	.5930	.5950	2600	1.0151	1.0173
1920	.4305	.4315	2155	.5000	.5050	2385	.5932	.5954	2610	1.0165	1.0180
1925	.4325	.4345	2160	.5080	.5100	2390	.5935	.5985	2620	1.0307	1.0329
1930	.4325	.4355	2165	.5110	.5130	2395	.6210	.6220	2630	1.0580	1.0590
1935	.4335	.4355	2170	.5120	.5130	2400	.6210	.6230	2640	1.0620	1.0635
1940	.4340	.4350	2175	.5120	.5140	2405	.6240	.6290	2650	1.1250	1.1350
1945	.4360	.4370	2180	.5150	.5170	2410	.6245	.6255	2660	1.1260	1.1270
1950	.4370	.4380	2185	.5150	.5210	2415	.6245	.6265	2670	1.1290	1.1300
1955	.4370	.4390	2190	.5155	.5205	2420	.6245	.6267	2680	1.4940	1.4950
1960	.4370	.4392	2195	.5156	.5178	2425	.6250	.6365	2690	1.4995	1.5015
1965	.4375	.4397				2430	.6250	.6300			

Solid Gauge for Fastener Holes

Cold Work Plug Gauges

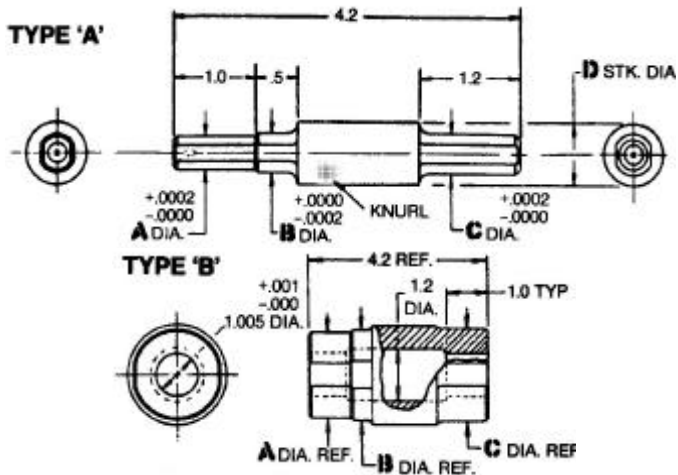

UNITED COLD WORK PLUG GAUGES

UDB-216005

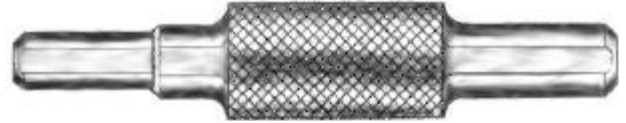

To order, specify above Part No. plus Dash No. below.
Example: UDB-216005-0615 = 3/8 (1st O.S.)

DASH NO.	NOMINAL FINAL HOLE SIZE	A GO	B NO GO	C GO	D DIA.	TYPE
0500	1/8	.1125	.1145	.1155	1/2	A
0505	5/32	.1430	.1460	.1470	3/8	A
0510	5/32 1st O.S.	.1590	.1620	.1630	3/8	A
0515	3/16	.1770	.1800	.1810	1/2	A
0520	3/16	.1795	.1821	.1825	1/2	A
0525	3/16 1st O.S.	.1926	.1956	.1966	1/2	A
0530	13/64	.1948	.1974	.1978	1/2	A
0535	3/16 2nd O.S.	.2082	.2112	.2122	1/2	A
0540	7/32	.2100	.2126	.2130	1/2	A
0545	1/4	.2350	.2380	.2400	1/2	A
0550	1/4	.2376	.2402	.2406	3/4	A
0555	1/4 1st O.S.	.2510	.2540	.2560	1/2	A
0560	17/64	.2531	.2557	.2563	3/4	A
0565	1/4 2nd O.S.	.2667	.2697	.2717	1/2	A
0570	9/32	.2686	.2712	.2722	3/4	A
0575	5/16	.2970	.3000	.3020	1/2	A
0580	5/16	.3006	.3032	.3039	3/4	A
0585	5/16 1st O.S.	.3131	.3161	.3181	1/2	A
0590	21/64	.3161	.3187	.3195	3/4	A
0595	5/16 2nd O.S.	.3293	.3323	.3343	1/2	A
0600	11/32	.3321	.3347	.3354	3/4	A
0605	3/8	.3590	.3620	.3640	1/2	A
0610	3/8	.3636	.3662	.3671	3/4	A
0615	3/8 1st O.S.	.3751	.3781	.3801	1/2	A
0620	25/64	.3791	.3817	.3827	3/4	A
0625	3/8 2nd O.S.	.3917	.3947	.3967	1/2	A
0630	13/32	.3951	.3977	.3986	3/4	A
0635	7/16	.4125	.4155	.4175	3/4	A
0640	7/16	.4210	.4240	.4260	1/2	A
0645	7/16 1st O.S.	.4371	.4401	.4421	1/2	A
0650	7/16 2nd O.S.	.4512	.4542	.4562	3/4	A
0655	1/2	.4719	.4749	.4769	3/4	A
0660	1/2	.4745	.4775	.4795	3/4	A
0665	1/2	.4811	.4838	.4846	3/4	A
0670	1/2 1st O.S.	.4901	.4931	.4951	3/4	A
0680	33/64	.4964	.4991	.4999	3/4	A
0690	3/8	.5015	.5038	.5038	3/4	A
0700	1/2 2nd O.S.	.5062	.5092	.5112	3/4	A

DASH NO.	NOMINAL FINAL HOLE SIZE	A GO	B NO GO	C GO	D DIA.	TYPE
0710	17/32	.5122	.5149	.5157	3/4	A
0730	9/16	.5370	.5400	.5420	3/4	A
0740	9/16 1st O.S.	.5526	.5556	.5576	3/4	A
0750	9/16 2nd O.S.	.5687	.5717	.5737	3/4	A
0770	5/8	.5975	.6005	.6025	3/4	A
0780	5/8 1st O.S.	.6131	.6161	.6181	3/4	A
0790	1/2	.6250	.6273	.6280	3/4	A
0800	5/8 2nd O.S.	.6317	.6347	.6367	3/4	A
0805	3/4	.7131	.7161	.7181	3/4	A
0815	3/4 1st O.S.	.7341	.7371	.7391	3/4	A
0820	13/16	.7745	.7775	.7795	1	A
0822	7/8	.8368	.8398	.8418	1	A
0824	29/32	.8740	.8760	.8790	1	A
0826	29/32 1st O.S.	.8896	.8916	.8946	1	A
0828	29/32 2nd O.S.	.9052	.9072	.9102	1	A
0830	15/16	.9062	.9092	.9112	1-1/4	A
0840	1	.9530	.9560	.9580	1-1/8	A
0842	1-1/16	1.0219	1.0249	1.0279	1-1/4	A
0844	1-1/8	1.0937	1.0967	1.1007	1-1/4	A
0850	1-3/16	1.1412	1.1442	1.1472	1-1/2	A
0851	1-3/16	1.1492	1.1522	1.1552	1-1/2	A
0852	1-3/8	1.3370	1.3390	1.3430	1-1/2	A
0853	1-3/8 1st O.S.	1.3526	1.3546	1.3586	1-1/2	A
0854	1-3/8 2nd O.S.	1.3682	1.3702	1.3742	1-1/2	A
0855	1-7/16	1.3957	1.3987	1.4017	1-1/2	A
0856	1-9/16	1.5156	1.5186	1.5216	1-3/4	A
0860	1-11/16	1.6563	1.6593	1.6623	2	A
0870	1-3/4	1.7109	1.7139	1.7169	2	A
0880	1-3/4 1st O.S.	1.7265	1.7295	1.7325	2	A
0890	1-3/4 2nd O.S.	1.7421	1.7451	1.7481	2	A
9000	2	1.9620	1.9650	1.9680	2	A
9010	2 1st O.S.	1.9776	1.9806	1.9836	2-1/8	A
9020	2 2nd O.S.	1.9932	1.9962	1.9992	2-1/8	A
9030	2-1/8	2.0625	2.0655	2.0685	2-1/4	B
9032	2-1/8	2.1093	2.1123	2.1173	2-1/2	B
9034	2-1/8	2.1466	2.1496	2.1546	2-1/2	B
9040	2-1/4	2.3750	2.3771	2.2170	3	A
9050	2-7/16	2.3906	2.3936	2.3966	2-1/2	B
9052	2-7/16	2.4320	2.4350	2.4400	2-3/4	B
9054	2-7/16	2.4690	2.4720	2.4770	2-3/4	B
9060	2-1/2	2.6250	2.6271	2.4700	3	A